

STATE OF NORTH CAROLINA, COUNTY OF ANSON.

THIS DEED, Made this 4th day of April, 1985, by

Hattie L. Price Coley (Widow)

of Anson County, North Carolina

grantor (whether one or more); to Ben F. Robinson and wife

, sometimes hereinafter called the

of Laura B. Robinson

grantee (whether one or more): 119 Delchester Court
Durham, N. C., 27713

, sometimes hereinafter called the

WITNESSETH, That in consideration of the sum of \$10.00----- paid to the grantor by the grantee, the receipt of which is hereby acknowledged, together with other good and valuable considerations, the grantor has bargained and sold, and by these presents does hereby grant, bargain, sell and convey to the grantee, and his, her or their heirs, successors and assigns, the following described land lying in Wadesboro Township, Anson County, and more particularly described as follows:

The same being Lot No. 6 in Block E according to a plat and survey of the West Side Extension of the property of George Singleton, made by A. F. Lyman, C.E., in July 1915, which said plat is duly recorded in Plat Book No. 1, at Page 37, to which said plat reference is hereby made, and all of the descriptions and references therein contained are by reference hereby expressly made a part of this instrument for a more complete description of said lot or parcel of land.

The same is also a portion of one of the lots of the THIRD TRACT according to that certain deed from J. Mack Coley and wife, Della Coley to Douglas R. Coley dated February 15, 1946 and recorded in Deed Book 100, Page 551, Registry of Anson County. See also Deed dated April 9, 1969 and recorded in the Anson County Registry in Deed Book 164, Page 629.

ANSON COUNTY 021079 STATE OF NORTH CAROLINA APR 12 '85 Real Estate Excise Tax PB. 10734 05.00

J. MACK & DELLA COLEY -TO- DOUGLAS R. COLEY

STATE OF NORTH CAROLINA

ANSON COUNTY

THIS DEED, made this the 15th day of February, 1946, by J. Mack Coley and wife, Della Coley, parties of the first part, to Douglas R. Coley, party of the second part, all parties being of Anson County, North Carolina, WITNESSETH:

THAT THE SAID PARTIES OF THE FIRST PART, for and in consideration of the sum of Ten (\$10.00) Dollars, and other valuable considerations to them in hand paid by the said party of the second part, the receipt and payment of which is hereby acknowledged, have bargained and sold, and by these presents do hereby bargain, sell, alien and convey unto the said Douglas R. Coley, party of the second part, his heirs and assigns, the following described tracts or parcels of land, lying and being in or near the Town of Wadesboro, Wadesboro Township, Anson County, North Carolina, and being more particularly described as follows, to-wit:

FIRST TRACT

Being near the Town of Wadesboro, and is Lot #47, as designated on a map and survey of the Caudle and Lawson lands, entitled "Map of Mid-Way," and having such metes and boundaries as appear upon said map. For a more complete description of said lot of land, reference is hereby made to the map aforesaid, which has been duly recorded in the office of the Register of Deeds, in Map Book 1, Page 89, and said map is hereby referred to and asked to be made a part of the description hereof. The same being all that parcel or lot of land conveyed to Miss Jessie Moore by T. L. Caudle and wife, and C. R. Lawson and wife under date of November 2, 1923, and registered in office of Register of Deeds for Anson County, in Book 63, on Page 551, etc., which deed is hereby referred to for more particular description of said lot.

The same also being that certain lot conveyed by Miss Jessie Moore to J. Mack Coley, by deed dated the 16th day of January, 1926, and recorded in the office of the Register of Deeds for Anson County, North Carolina, in Deed Book 166, Page 79, to which deed reference is hereby made.

SECOND TRACT

Being Lot No. 48, as designated on a map and survey of the Caudle and Lawson lands, entitled "Map of Mid-Way," and having such metes and boundaries as appear on said map. For a more complete description of said lot of land reference is hereby made to the map aforesaid, which said map has been duly recorded in the office of the Register of Deeds, in Map Book No. 1, Page 89, to which reference is hereby made, and said map is asked to be made a part of the description hereof.

The same being that certain lot conveyed on the 2nd day of November, 1923, by T. L. Caudle, C. R. Lawson, et al., to J. Mack Coley, the deed therefor being recorded in the office of the Register of Deeds for Anson County, North Carolina in Deed Book 71, Page 122, to which deed reference is hereby made.

THIRD TRACT

Lots Nos. One (1), Two (2), Three (3), Four (4) and Five (5), in Block C; and, Lots Nos. One (1), Two (2), Three (3), Four (4) and Nine (9), in Block D; and, Lots Nos. Five (5) and Six (6), in Block E. All according to a plat and survey of the West Side Extension of the property of George Singleton, made by A. F. Lyman, C. E., in July, 1915, which said plat is duly recorded in the office of the Register of Deeds for Anson County, North Carolina, in Plat Book No. 1, at Page 37, to which said plat reference is hereby made, and all of the descriptions and references therein contained are hereby expressly made a part of this instrument for a more complete description of said lots or parcels of land.

The same also being twelve (12) of those certain lots conveyed by the Anson Real Estate & Insurance Company, a corporation, to J. Mack Coley, by deed dated the 9th day of March, 1921, and recorded in the office of the Register of Deeds for Anson County, North Carolina, in Deed Book 59, Page 261, to which deed reference is hereby made.

FOURTH TRACT

Being Lot No. 9, in Block B, as described and contained in a certain map or plat made in 1915 by A. F. Lyman, C. E., of a part of the Singleton land and known as West Side Extension, which said map or plat is on file in the office of the Register of Deeds for Anson County, in Plat Book No. 1, Page 37, reference to which is hereby made.

The same also being that certain lot conveyed by the Anson Real Estate & Insurance Company, a corporation, to J. Mack Coley, by deed dated the 2nd day of December, 1926, and recorded in the office of the Register of Deeds for Anson County, North Carolina, in Deed Book 71, Page 89, to which deed reference is hereby made.

FIFTH TRACT

Adjoining the lands of J. Mack Coley, Shaver and others, (then or now), and bounded as follows, viz:

Beginning at a rock in the Singleton (then or now) line at the North corner of the aforesaid two acre tract or lot, and runs with the Singleton (then or now) line N. $33\frac{1}{2}$ E. 2.41 chs., to a stake, Jarius White's most Westerly corner of an acre lot; then S. $46\text{-}\frac{3}{4}$ E. 3.25 chs., to a stake in Nancy Holcomb's line; then with her line S. $33\frac{1}{2}$ W. 1.51 chs., to a stake at the most Easterly corner of James Edwards, or his wife's lot; thence N. $61\frac{1}{2}$ W. 3.17 chs., to the beginning, and being all of that lot or tract of land conveyed to Dora and Minnie Gatewood by J. S. Liles, by a deed dated the 2nd day of May, 1927, and recorded in the office of the Register of Deeds for Anson County, in Deed Book 67, at Page 882, etc., to which reference is made for a more complete description.

The same being that certain parcel of land conveyed by Dora Gatewood, et al, to J. Mack Coley, by deed dated the 10th day of February, 1938, and recorded in the office of the Register of Deeds for Anson County, North Carolina, in Deed

Book 82, Page 30, to which deed reference is hereby made.

SIXTH TRACT

Beginning at a point in Maple Lane near the West side of said Street and runs thence S. $84\frac{1}{2}$ E. 265.3 ft. with a line of the Silk Mill property to John Lineberry's Northwest corner; thence with his West line S 17.00 W 40 ft to Lineberry's Southwest corner; thence S. 14.20 E 119.32 ft. to a stake, Sallie Edward's Northeast corner; thence with her North line N. $86\text{-}\frac{3}{4}$ W 127 ft. to a point in Maple Lane; thence along said Street in a Southeasterly direction 54.65 ft. to a point in said Street; thence N. $86\text{-}\frac{3}{4}$ W. 37.1; thence with the West edge of said Street 5 ft more or less; thence S 72 W 10.3 ft.; thence N. 34 W. 267.3 ft. to the point of Beginning. The same being Lots 7, 8, 9, 10, 11 and 12 in Block A., and Lot 5 in Block B, as shown on a plat made, or supposed to have been made, by A. F. Lyman, in Dec. 1927, said plat being entitled "J. W. Odom Est. - Julius A. Little tract."

The same also being a part of that certain "First Tract" described in that certain deed from H. H. McLendon and H. P. Taylor, Commissioners, to J. Mack Coley, dated the 30th day of March, 1931, and recorded in the office of the Register of Deeds for Anson County, North Carolina, in Deed Book 83, Page 178, to which deed reference is hereby made.

TO HAVE AND TO HOLD the above described tracts or parcels of land, together with all privileges and appurtenances thereto belonging or in anywise thereunto appertaining unto him, the said Douglas R. Coley, party of the second part, his heirs and assigns, forever in fee simple absolute.

AND THE SAID PARTIES OF THE FIRST PART, for themselves, their heirs, executors, administrators and agents, covenant to and with the said party of the second part, his heirs and assigns, that they are seized of the above described tracts, lots or parcels of land and premises in fee, and that they have the right to convey the same in fee simple; that the same are free and clear from any and all encumbrances, and that they do hereby forever warrant and will forever defend the title to the same against the lawful claims of all persons whomsoever.

IN TESTIMONY WHEREOF, the said parties of the first part, J. Mack Coley and wife, Della Coley, have hereunto set their hands and seals, this the day and year first above written.

J. Mack Coley (SEAL)

Della Coley (SEAL)

STATE OF NORTH CAROLINA

ANSON COUNTY

I, Frances G. Horne, a Notary Public, of Anson County, North Carolina, do hereby certify that this day personally appeared before me J. Mack Coley and wife, Della Coley, and each did duly acknowledge the due execution of the foregoing Deed of Conveyance for the purposes therein expressed.

WITNESS my hand and Notarial Seal, this the 21 day of February, 1946.

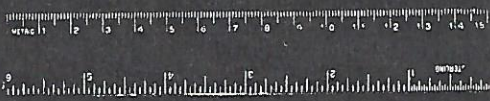

97

99

J. T. Trench

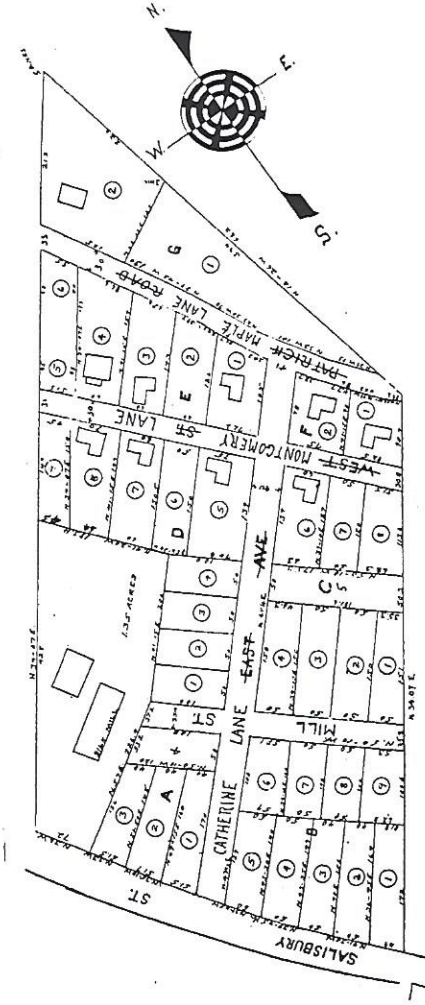

WEST SIDE EXTENSION
 Geo. Simoleton
 July 1915

Scale, 100 Feet to an Inch

